

COORDINATE SCHEDULE					
	NORTH	EAST			
1.	642230.33	803884.68	28.	642209.14	803562.46
2.	642109.10	803739.42	29.	642425.38	803717.37
3.	641772.18	803539.45	30.	642414.11	803733.11
4.	641726.67	803621.55	31.	642277.47	803642.30
5.	641714.98	803725.90	32.	641968.50	803445.78
6.	641659.60	803719.69	33.	641951.96	803435.21
7.	641654.03	803769.38	34.	641800.23	803337.86
8.	641638.77	803905.52	35.	641760.91	803343.98
9.	641585.91	803918.42	36.	641751.17	803355.12
10.	641568.93	803885.31	37.	641540.58	803583.48
11.	641487.65	803862.14	38.	641487.74	803654.35
12.	641453.97	803871.71	39.	641500.86	803690.68
13.	641406.09	803886.08	40.	641595.72	803712.53
14.	641394.16	803821.04	41.	641590.15	803762.22
15.	641237.64	803790.44	42.	641480.53	803736.50
16.	641290.59	803652.47	43.	641447.36	803755.57
17.	641311.67	803607.12	44.	641402.73	803725.61
18.	641374.42	803484.72	45.	641388.76	803696.63
19.	641281.51	803451.55	46.	641406.64	803649.84
20.	641307.16	803377.99	47.	641438.70	803639.27
21.	641365.42	803235.82	48.	641503.83	803549.58
22.	641407.87	803268.47	49.	641714.42	803321.23
23.	641512.89	803131.90	50.	641715.37	803320.19
24.	641433.32	803070.09	51.	641710.64	803275.58
25.	641448.30	803033.54	52.	641567.56	803173.33
26.	641536.42	803101.30	53.	641534.58	803148.75
27.	641787.50	803294.38			

TABLE OF CURVE DATA					
No.	RADIUS	LENGTH	TANGENT	Δ	CHORD BEARING & DISTANCE
53-52	1029.02'	41.13'	20.57'	02°17'25"	N36°41'50" E 41.13'
33-32	5000.00'	19.64'	9.82'	00°13'30"	N32°34'17" E 19.64'
31-30	4098.26'	164.08'	82.05'	02°17'38"	N33°36'22" E 164.07'
35-36	275.00'	14.80'	7.40'	03°04'59"	S48°51'12" E 14.80'
37-38	425.00'	98.56'	44.44'	11°56'19"	S53°17'13" E 88.39'
39-40	425.00'	97.56'	48.99'	13°09'07"	N12°58'17" E 97.34'
42-41	475.00'	112.87'	56.70'	13°36'53"	N13°12'09" E 112.60'
43-12	250.00'	117.40'	59.80'	26°54'23"	S36°44'19" W 116.33'
44-13	300.00'	152.50'	83.30'	31°02'02"	N68°48'15" E 160.52'
50-49	225.00'	1.42'	0.71'	00°21'38"	S47°27'44" E 1.42'
13-14	300.00'	66.27'	33.27'	12°39'21"	S79°36'22" W 66.13'
48-47	475.00'	111.09'	55.80'	13°24'02"	S54°01'04" E 110.84'

92

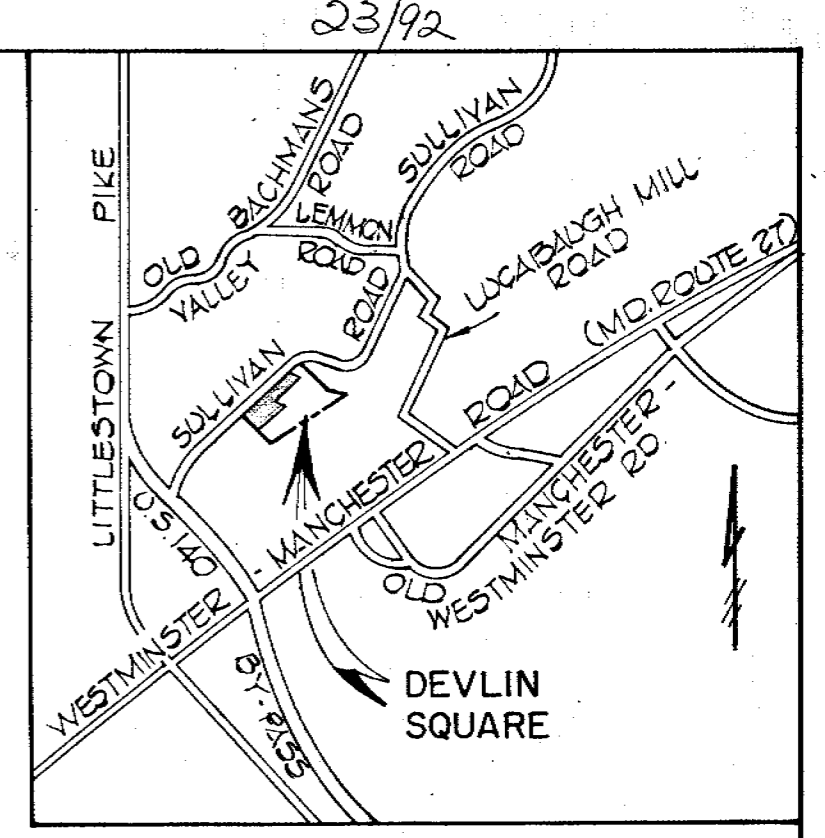

NOTE: COORDINATES SHOWN HEREON ARE REFERENCED TO THE MARYLAND STATE GRID SYSTEM.

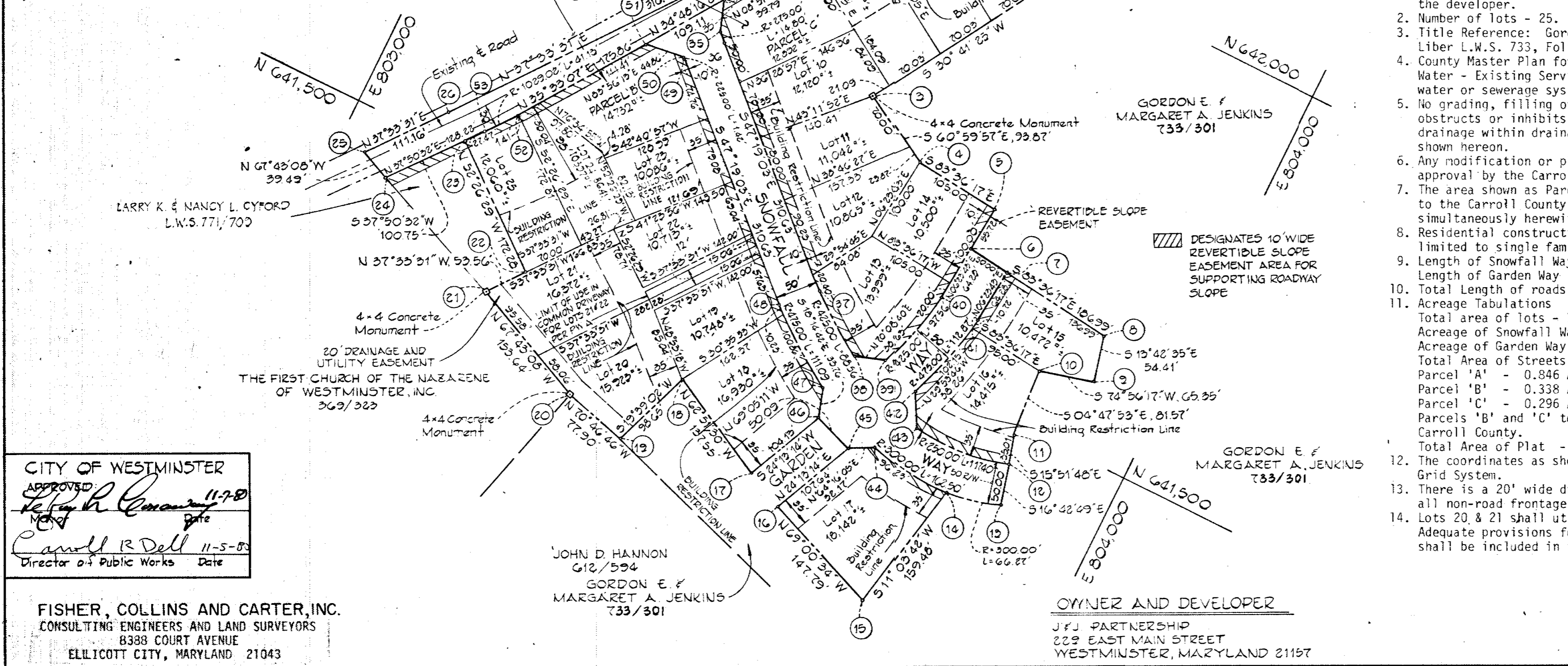

GENERAL NOTES

- Where applicable, utilities shall be installed in accordance with the current regulations, or as may hereafter be amended of the Public Service Commission of Maryland regarding underground service, and may require pre-construction refundable deposits from the developer.
- Number of lots - 25.
- Title Reference: Gordon E. Jenkins and Margaret A. Jenkins Liber L.W.S. 733, Folio 301 Dated February 2, 1979.
- County Master Plan for Water and Sewerage, 1978-79 Water - Existing Service, Sewer - Existing Area, No individual water or sewerage systems shall be permitted.
- No grading, filling or construction shall be permitted which obstructs or inhibits the surface flow of natural or storm water drainage within drainage or drainage and utility easements as shown hereon.
- Any modification or plat re-assembly shall be subject to approval by the Carroll County Planning and Zoning Commission.
- The area shown as Parcel A, containing 0.846 acre, is to be conveyed to the Carroll County Commissioners by deed intended to be recorded simultaneously herewith.
- Residential construction on any of the lots shown hereon is limited to single family dwellings.
- Length of Snowfall Way - 690'±.
Length of Garden Way - 224'±.
- Total Length of roads - 978'±.
- Acresage Tabulations
Total area of lots - 7.248 Acres ±.
Acresage of Snowfall Way - 0.814 Acre ±.
Acresage of Garden Way - 0.285 Acre ±.
Total Area of Streets - 1.099 Acres ±.
Parcel 'A' - 0.846 Acre ±.
Parcel 'B' - 0.338 Acre ±.
Parcel 'C' - 0.296 Acre ±.
Parcels 'B' and 'C' to be conveyed to County Commissioners of Carroll County.
Total Area of Plat - 9.827 Acres.
- The coordinates as shown hereon are based on Maryland State Grid System.
- There is a 20' wide drainage and utility easement centered on all non-road frontage lot lines, unless otherwise shown hereon.
- Lots 20 & 21 shall utilize the use in common driveway as shown hereon. Adequate provisions for use in common and the method of maintenance shall be included in the original deeds of conveyance.

CITY OF WESTMINSTER
APPROVED: *[Signature]* 11-7-80
Date
[Signature] 11-5-80
Director of Public Works Date

FISHER, COLLINS AND CARTER, INC.
CONSULTING ENGINEERS AND LAND SURVEYORS
8388 COURT AVENUE
ELICOTT CITY, MARYLAND 21043

CARROLL COUNTY HEALTH DEPARTMENT APPROVAL
BY *[Signature]* DATE 11/10/80
Community water and sewerage systems are in conformance with the Carroll County Master Plan for Water and Sewer
Maryland State Department of Health
Water Permit No. 80-12-709 Issued JULY 10, 1980
Sewer Permit No. 80-22-710 Issued JULY 10, 1980
CARROLL COUNTY PLANNING AND ZONING COMMISSION APPROVAL
BY *[Signature]* DATE DEC 19 1980
SECRETARY
FOR BUREAU OF UTILITIES
BY *[Signature]* DATE 11-19-80

OWNER'S CERTIFICATE
We, owners of the property shown hereon, and described in the surveyor's certificate, hereby adopt this plan of subdivision, establish the building lines as shown, and certify that the requirements of Section 3-108 of the Real Property Article of the Annotated Code of Maryland (1974) as amended pertaining to the preparation of record plats, and subsequent acts, if any, amendatory thereto as far as they relate to the preparation of this plat and the setting of markers have been complied with. New streets, roads, open spaces and the mention thereof in deeds, are for the purpose of description only and the land so shown is expressly reserved in the present owner's shown on this plan, their successors, heirs and assigns. No more than one principal building shall be permitted on any residential lot, and no such lot may ever be resubdivided so as to produce a building site of less area or width than the minimum required by applicable health, zoning or other regulations. Community water and sewerage facilities will be available to all lots offered for sale.
OWNERS: *[Signature]*
WITNESS: *[Signature]* Date 8/24/79

SURVEYOR'S CERTIFICATE
I, Terrell A. Fisher, a registered land surveyor of the State of Maryland, do hereby certify that the land shown hereon has been laid out and the plat prepared in compliance with Section 3-108 of the Real Property Article of the Annotated Code of Maryland (1974) as amended pertaining to the preparation of record plats.
[Signature] August 28, 1979
Terrell A. Fisher, L.S. #10692 Date

SECTION ONE
DEVLIN SQUARE
LOTS 1-25
CARROLL COUNTY, MARYLAND
7TH ELECTION DISTRICT
SCALE: 1" = 100' AUGUST 22, 1979

CARROLL COUNTY CIRCUIT COURT (Plat Book) Plat Book LWS-23, p. 92, MSA-C2426-3675. Date available 1980/12/19. Printed 07/15/2021.

